

**Percussion Competition Flow Map**

Blue arrows represent the pathway to the Performance Area

Red arrows represent pathways after performance. Units will move equipment down the main hallway and out the front door to the trailer parking area.

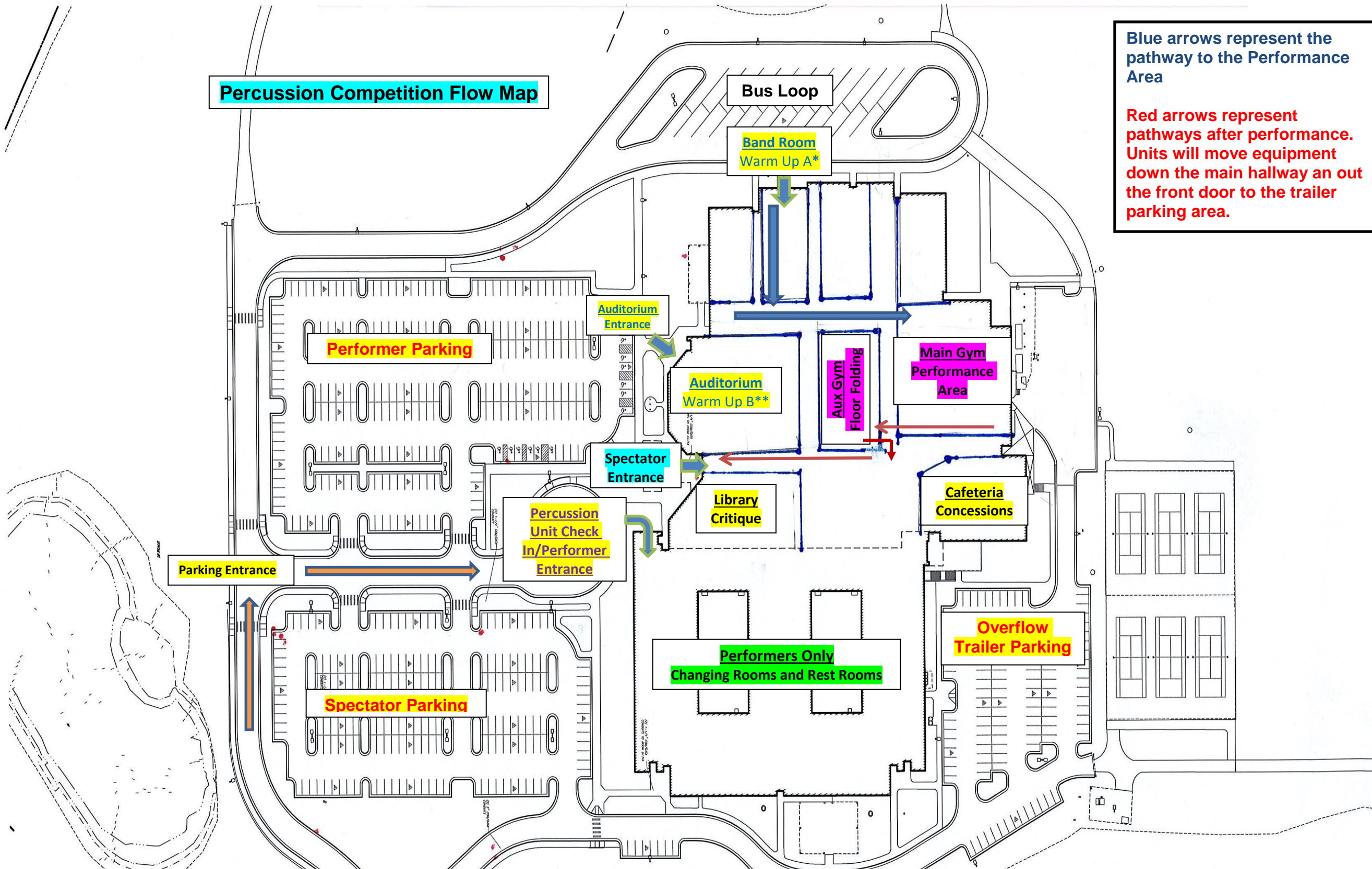

\*Units using Warm Up A - enter through the band room doors by the bus loop

\*\*Units using Warm Up B - enter through the outside auditorium doors.

\*\*\*Performer Entrance – location of changing rooms and rest rooms for performers prior to warm up.