

SHERANDO HIGH SCHOOL
Percussion/Winds

SCHOOL: Sherando High School

ADDRESS: 185 South Warrior Drive, Stephens City, VA 22655

POC/EMAIL/PHONE: Kayla Wright/kaytay0903@gmail.com/317-341-4073

Joel Costner/540-869-0060

TRAVEL OUTSIDE DURING MIGRATION: No

GYM PERFORMANCE AREA: 60' X 94'

GYM ENTRY DOOR WIDTH: Double wide with center bar removed

GYM EXIT DOOR WIDTH: Double wide with center bar

EQUIPMENT PROP STAGING AND/OR STOWING:



← Performer's View to the Judges.

CEILING HEIGHT: 45'

OBSTRUCTIONS: Ceiling Beams & Lights

TIMING LINE: Vertical

Judges View from the press box.

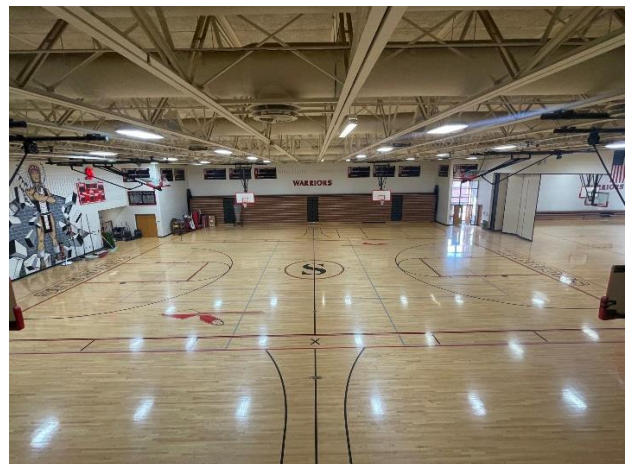

WARMUP A: Stage
SEPARATE ENTRANCE AND EXIT: Yes
WARMUP B MEASUREMENTS: Approx 20' x 25'
OBSTRUCTIONS: YES – Curtains



Auditorium will also be used for unit holding. Curtain will be closed during warm up.

Enter Warm up A to the right of the stage as you look at it and exit to the left.



WARMUP B ROOM: Band Room

SEPARATE ENTRANCE AND EXIT: Yes (entrance is single wide and exit is double wide)

WARMUP MEASUREMENTS: 50' x 39'

OBSTRUCTIONS: Risers as shown in the middle image below – battery can stand on risers to warm up and front ensemble instrumentation can remain off the risers.

SEE IMAGES AT THE ENDS OF THIS DOCUMENT

If you decide to warmup out, you will enter the school at Door 20 to enter the gym to perform.



FLOOR FOLDING – space is just outside the main gym and near concessions



OUTSIDE MAP





All AIA contest sites must have a minimum of 70' x 110' of gym area to accommodate a five (5) foot "safety zone" from spectator seating. If no spectators are seated on the left or right sides of the gym area, then the "safety zone" will be eliminated on the left and right sides of the competition area and can extend to the maximum of 70' x 110'.

The "competition area" at this event measures approximately 60' X 94'. All performing groups must be prepared to perform within that area. Floor tarps may not extend into the "safety zones" per rules found in the Winterguard International Adjudication Manual and Rulebook.

BACKSIDE SEATING

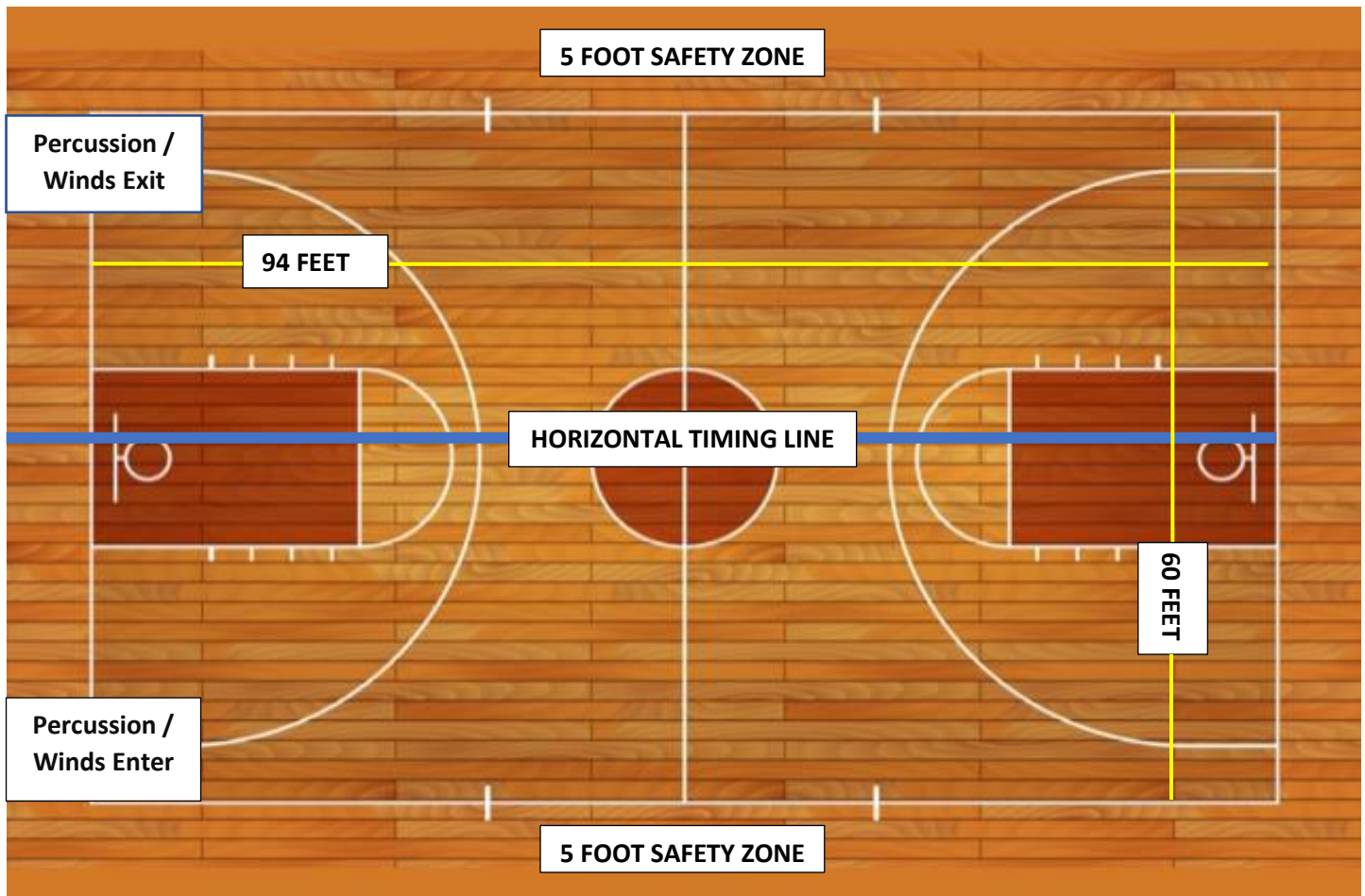

SPECTATOR SEATING

Band Room- Warm Up B

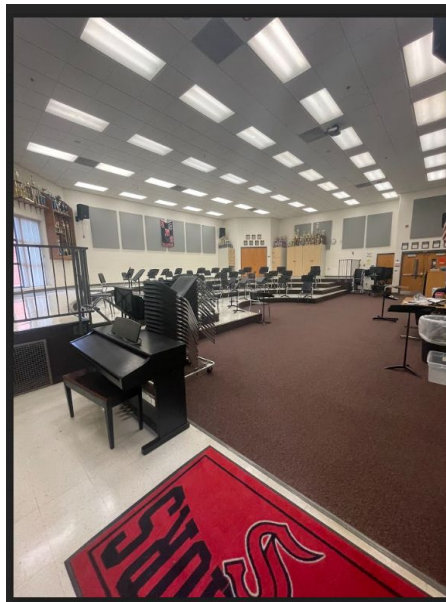

Percussion w/ Unit Holding

- A-Unit Check In (Door #3)
- B-Percussion Warm Up A & Unit Holding (Auditorium)
- ***Curtain will be closed
- C-Warm Up B (Band Room)
- D-Main Gym
- E-Floor Folding (Cafeteria)
- F-PERCUSSION Tarp/Prop/Equipment LOADING & UNLOADING(Door #10)
- G-Spectator entrance (Door #1)
- H-SPECTATOR gym entrance
- I-Cafeteria
- J-Bathrooms
- K-Director's Hospitality (Library)
- L-Tabulation (Library-Work Room)
- M-Judge's Hospitality & Critique (Library-Creative Commons)
- N-Additional Bathrooms for units

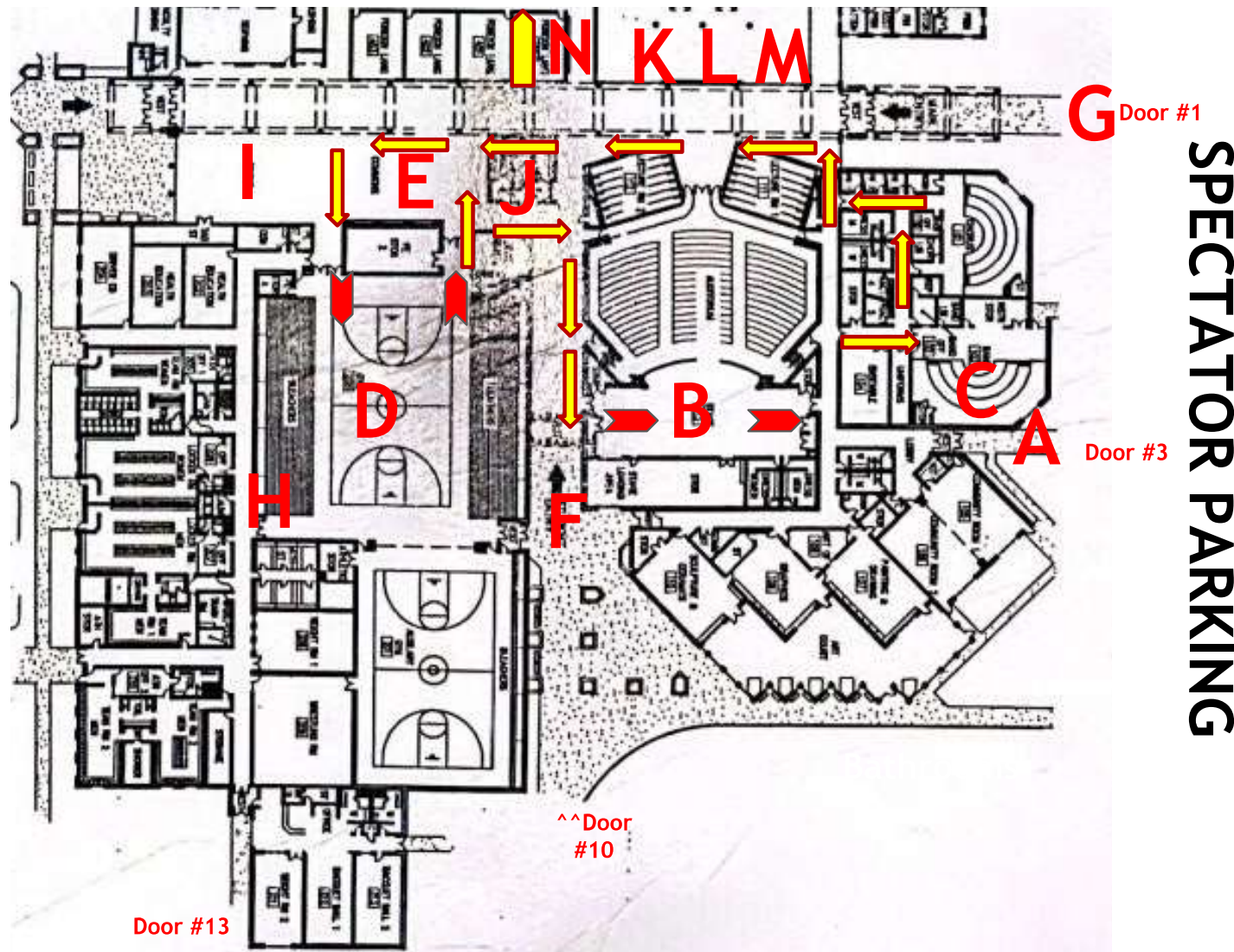

BUS/TRUCKS/OVERFLOW SPECTATOR PARKING

Parking-Overview



- Spectators turn left after entering gates
- Units drop off in bus circle
- Buses and trailers park in student lot; overflow by pool at Sherando Park
- ALL vehicles Exit through Sherando Park