

### From I-540

- Take exit 62 for Green Level West Rd toward Cary
- Turn right onto Green Level W Rd
- Turn left onto NC-1600
- Turn left onto Roberts Rd.

### From US-64

- Take the Kelly Rd exit
- Turn left onto Kelly Rd
- Continue onto NC-1600
- Turn Right onto Roberts Rd.

# Green Level High School

Buses

## GUARD FLOW

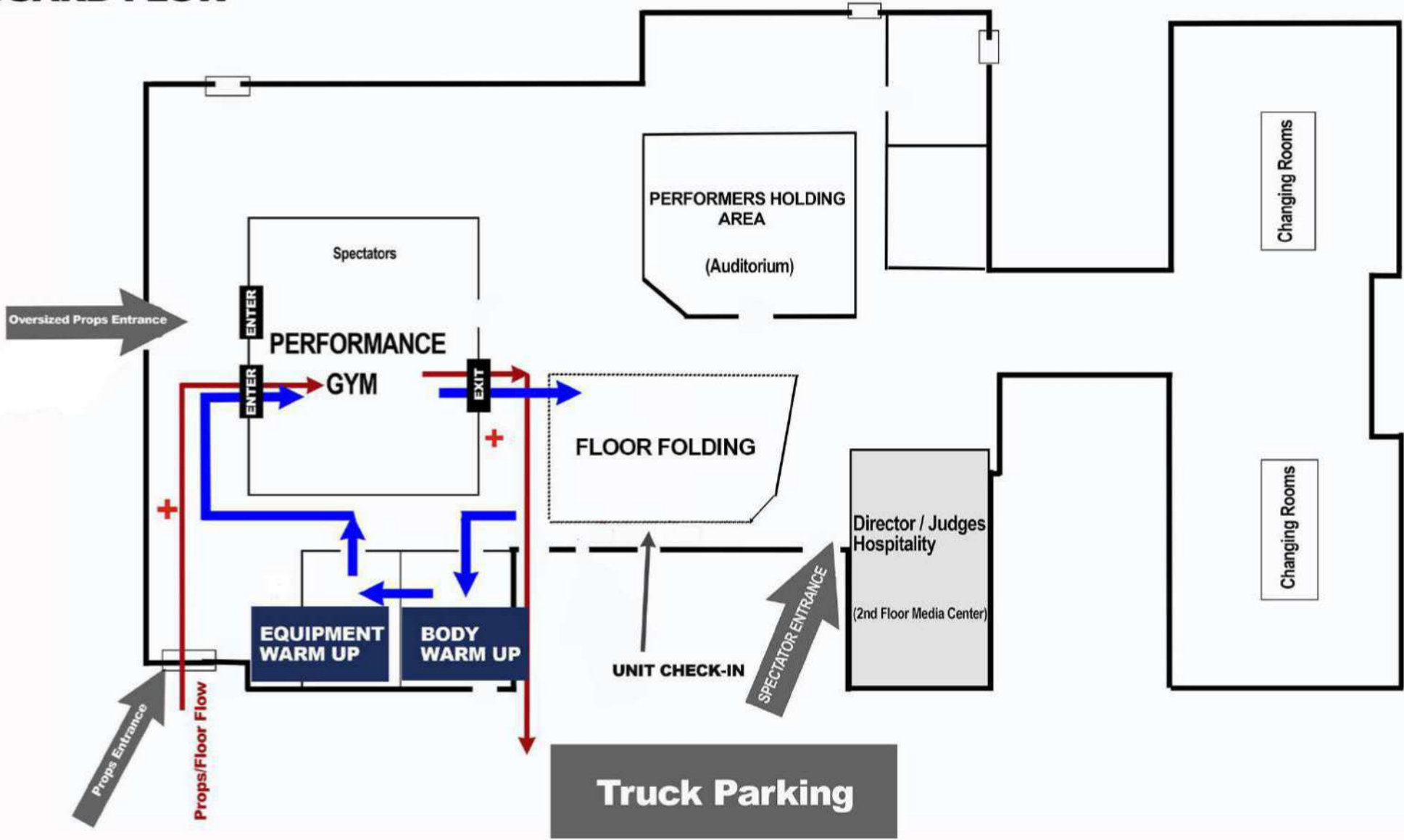

# Green Level High School

Buses

## Percussion/Winds - A FLOW

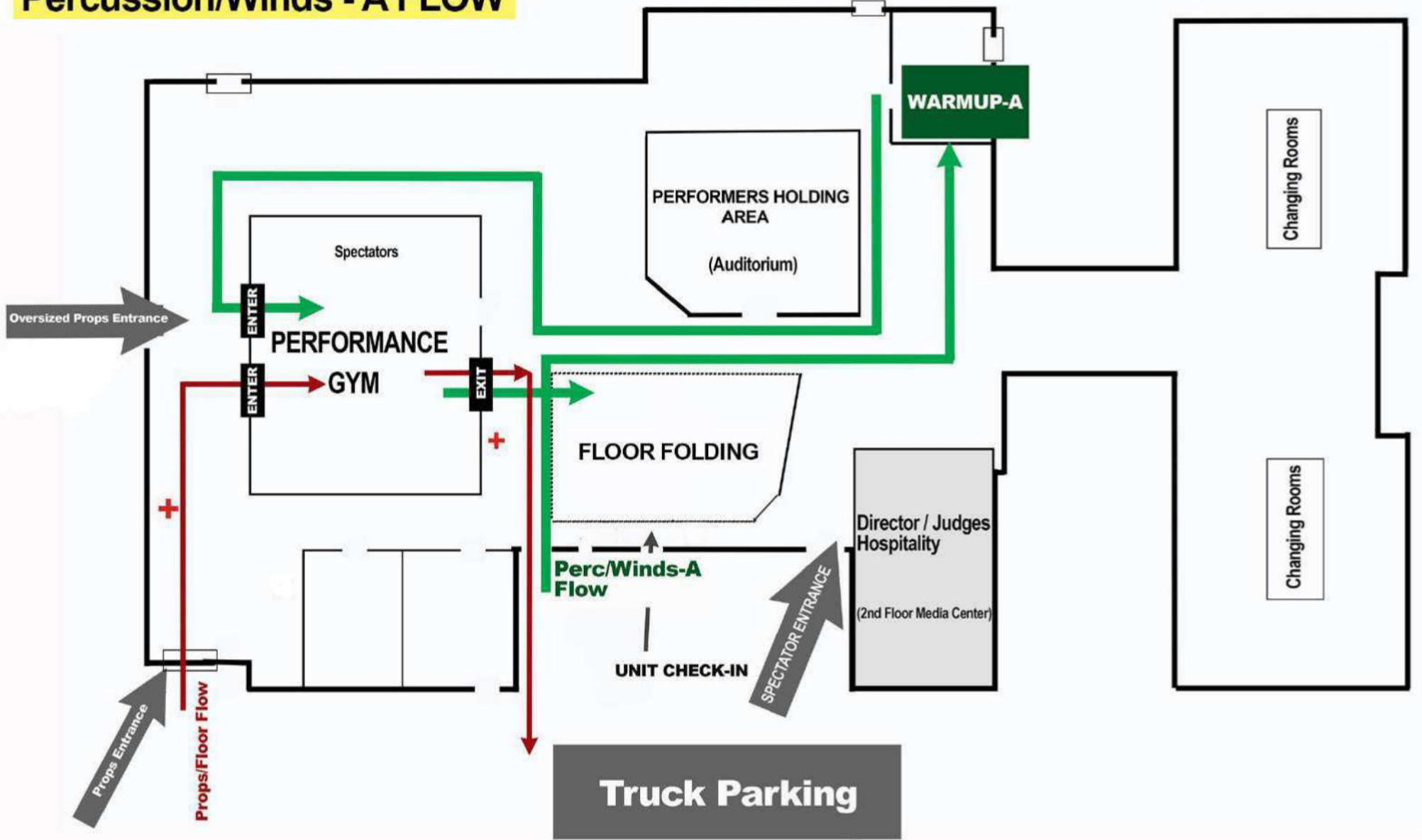

# Green Level High School

Buses

## Percussion/Winds - B FLOW

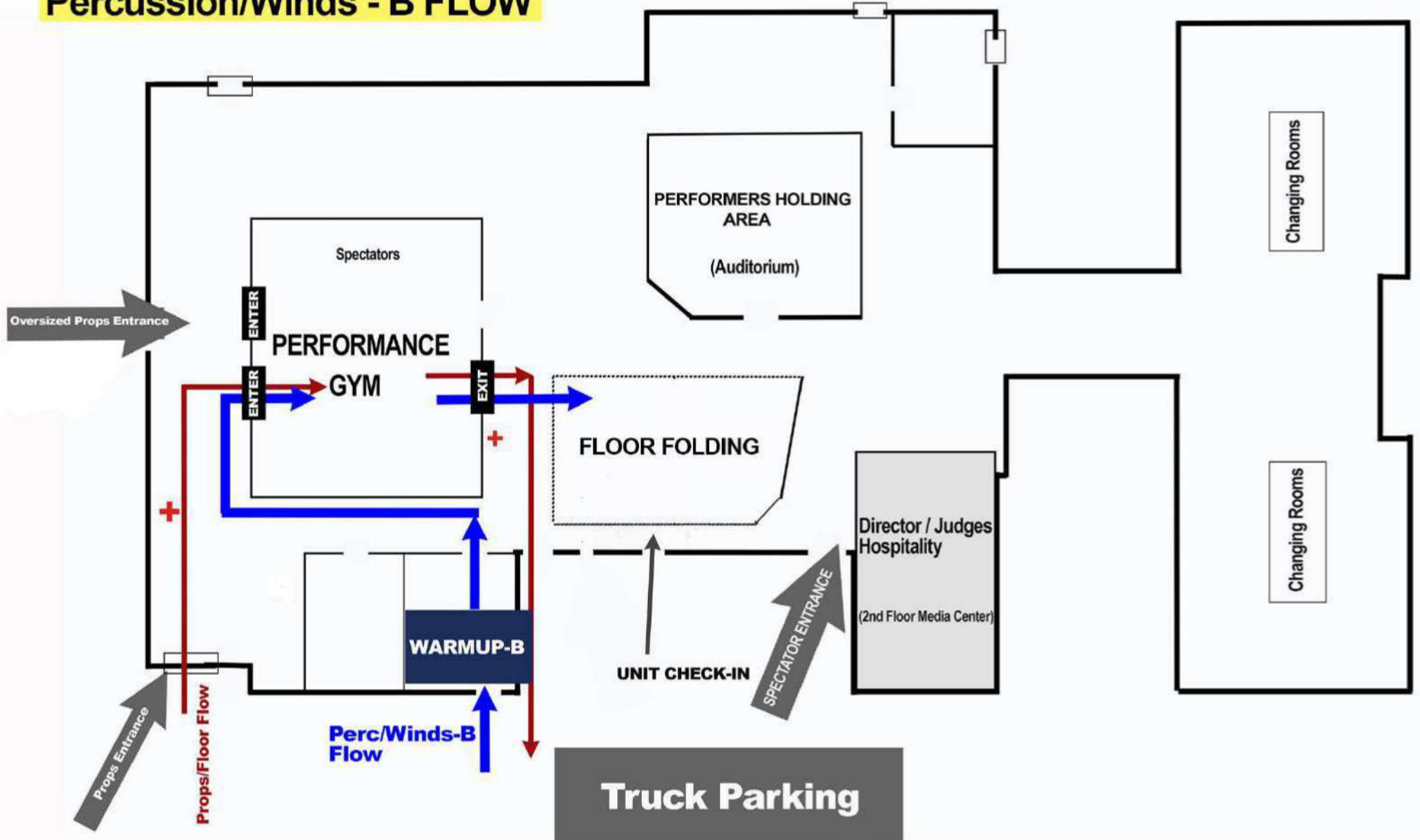

location name Green Level High School

Minimum Performance Area 60 x 90

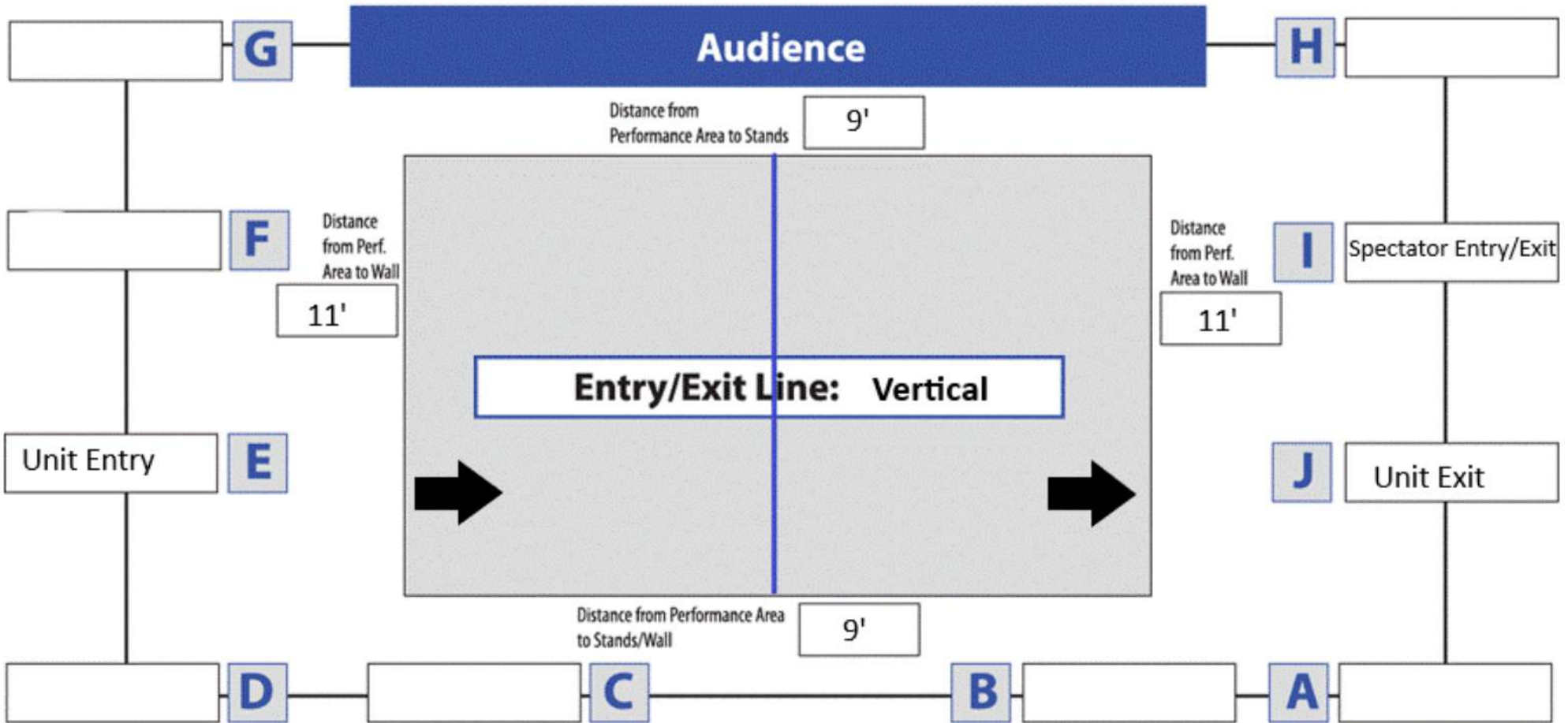

Minimum Ceiling Height Lowest Point including beams/rafters

Are there any low-hanging obstructions? (Basketball/Volleyball nets?)   
Note in red on diagram

Are the gym Entry/Exit doors Single-Wide, Double-Wide, or Double-Wide with non removable bar?

Exact dimensions of Entry/Exit door to be used at the show